

MECHAN CONTROLS



Installation Guide : MT-10DC02

Keep this guide for future reference

This information is designed to help suitably qualified personnel install and operate Mechan equipment. Before using this product, read this guide thoroughly along with any relevant European and/or National standards e.g. Machinery Directive 2006/42/EC and it's amendments, Provision and Use of Work Equipment Regulations.

Further information can be obtained from Mechan Controls

Description

The MT10DC02 is a standard magnetically operated single contact switch.

1 X NO Contact encapsulated in an ABS housing. Pre-wired with 2 metres of cable.



Operation

The MT 10DC02 is a standard magnetically operated switch with 1 x NO contact. The actuator can approach the switch from any direction, but when in place the targets should be aligned. (as shown)

When the switch is within the specified operating distance the NO contact will close. When the actuator is moved away from the switch the NO contact wil open.

To avoid physical damage, do not use the switch and actuator as a stop, leave a 1-2 mm gap for best operation and tolerance to machine guard vibration.

Mount the switch on to the machine frame and the actuator on to the opening edge of the door.

Always try to mount the switch on non-ferrous material. (Ferrous materials may reduce the switching distance.)

Minimum separation 50mm between adjacent switches.

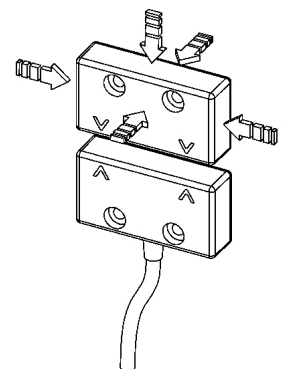

Connections & Fuses

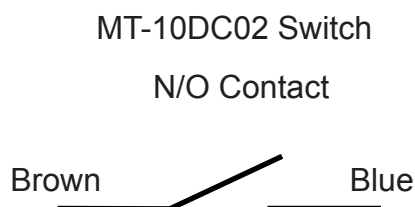

NOTE -

Contact closes when actuator brought within operating range.

It is recommended to use a quick blow 300mA fuse to protect the MT 10DC02 contact. Damage to the contact through over current / voltage cannot be repaired as the contact is encapsulated.

Dimensions

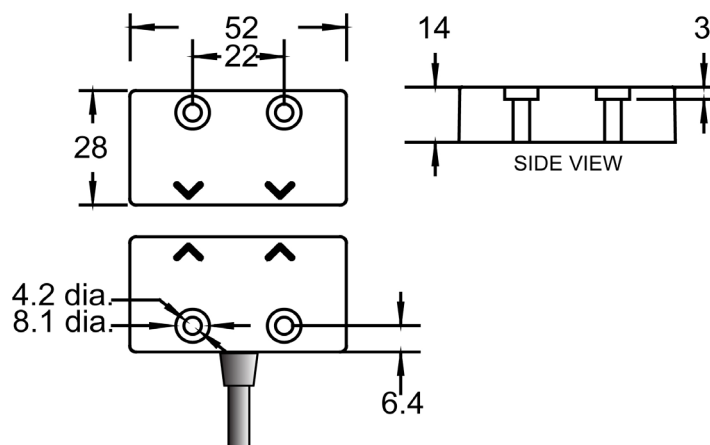

Technical Specifications

MT 10DC02	
Operation	Magnetic Non-contcat
Contact Arrangements	1 x N/O
Contact Operating Distance	Approx 12mm
Contact Rating	DC: 24Vdc / 300mA
External Fusing (Customer Supplied)	300mA Quick Blow
Dimensions	See above
IP Rating	IP67
Cable Type / Length	2 Core, 2 Metres
Operating temperature	-25°C to +55°C
Storage temperature	-25°C to +55°C
Mounting	Target to target
Construction	Red ABS Resin Filled

Maintenance

It is recommended to check the safe operation of the of the switches and look for signs of damage or excessive wear on a weekly basis. Damaged units should be replaced or returned to the manufacturer for repair where practical.

Notes

In the interest of product development specifications are subject to change without notice.

It is the responsibility of the user to ensure compliance with any acts or by-laws in place.

All information regarding Mechan equipment is believed to be accurate at the time of printing. Responsibility cannot be accepted for errors or omissions.

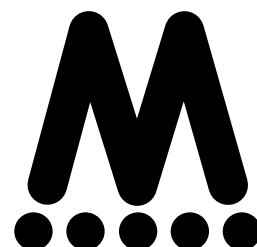

MECHAN CONTROLS PLC

14/16 SEDDON PLACE, STANLEY INDUSTRIAL ESTATE
SKELMERSDALE , LANCASHIRE WN8 8EB
UNITED KINGDOM

Telephone :+44(0)1695 722264

web : www.mechancontrols.co.uk